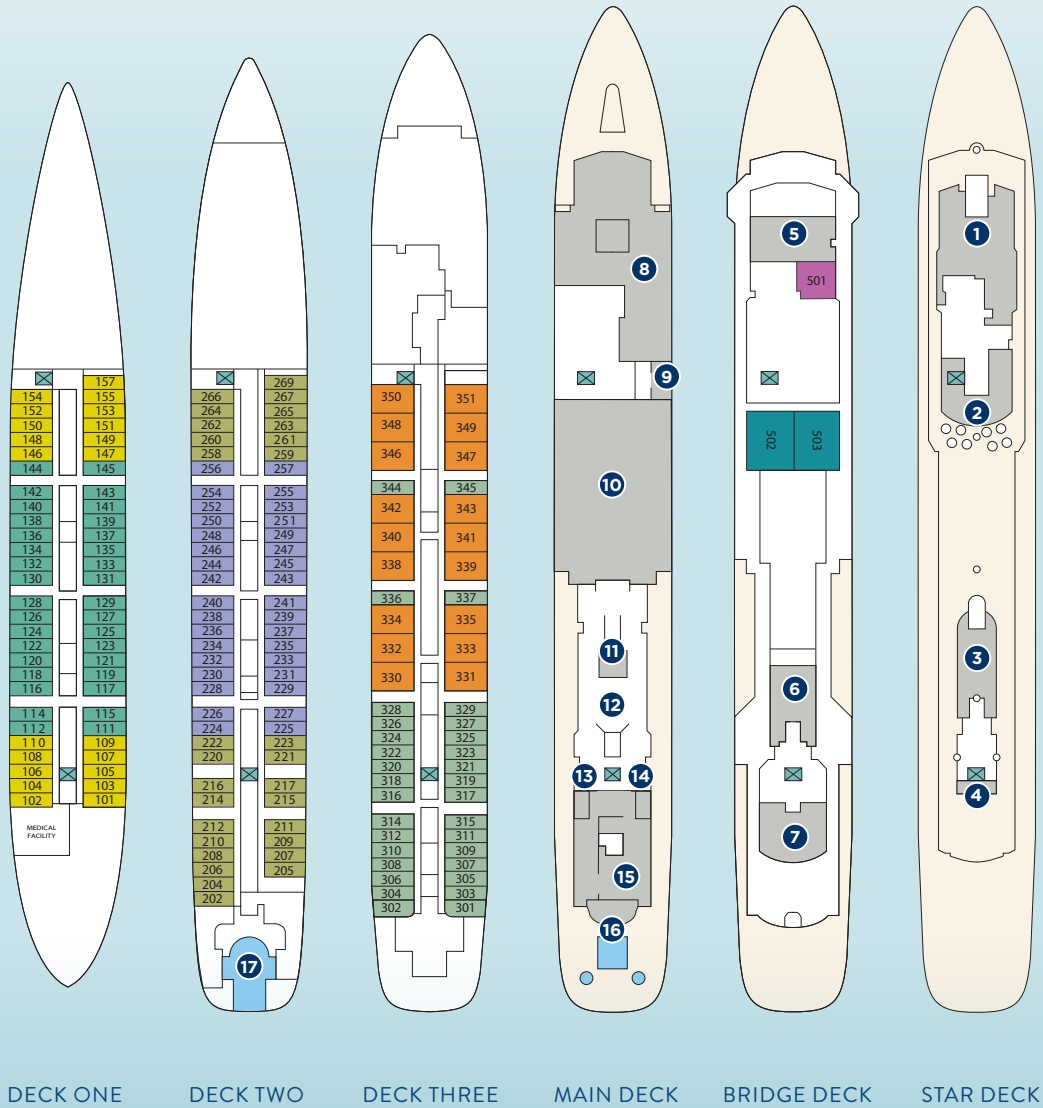

DIAGRAM KEY

- Broadmoor 502
Sea Island 503
- Owner's Suite
- Suites
- Category TX
- Category AX
- Category A
- Category BX
- Category B
- Public Spaces
- Stairs / Elevator



WIND SURF

FIVE-MASTED SAILING YACHT
(342 GUESTS)

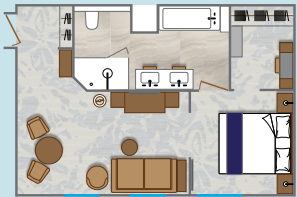

BROADMOOR &
SEA ISLAND SUITES

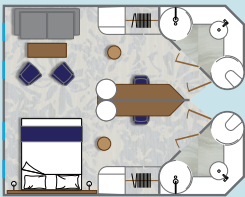

SUITE

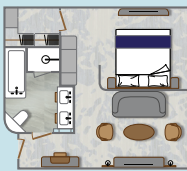

OWNERS' SUITE

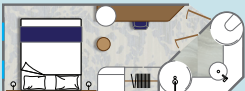

STATEROOM



Lobby & Reception Rendering



Owners' Suite Rendering

WIND CLASS

ONBOARD SPACES:

- | | |
|-------------------------|---------------------------------|
| 1 Stella Bistro | 10 Lounge |
| 2 Veranda/Candles | 11 Reception |
| 3 Fitness Center | 12 Yacht Club Café |
| 4 Terrace Bar | 13 Cruise Consultant Desk |
| 5 Bridge | 14 Destination Desk |
| 6 World Spa by Windstar | 15 Star Boutique |
| 7 Compass Rose Bar | 16 Pool / Pool Bar / Whirlpools |
| 8 Amphora Restaurant | 17 Watersports Platform |
| 9 Amphora Wine Room | |



Wind Surf

Access to board ship is via stairs only.
Access to/from outside deck may require assistance with doors and thresholds.

STATEROOMS & SUITES

Broadmoor and Sea Island
Suites: 495 square feet
(46 square meters)

Owner's Suite:
242 square feet
(22.5 square meters),
1 bathroom

Suites: 376 square feet
(35 square meters),
2 bathrooms

Staterooms: 188 square feet
(18 square meters)

Staterooms with 3rd Berths:
117-140; all suites

**Staterooms with One Queen
Size Bed Only (no twin option):**
101, 102, 157, 202, 204, 269,
301-302, 303-304

WIND SURF undergoes a refresh in December 2024. The refresh brings the tight-knit connection of the Windstar community to the forefront through the redesign of public spaces and staterooms. From a revamped lobby to a new pool and larger pool bar, new *World Spa by Windstar* to a redesigned lounge, this initiative also includes intricate details like new teak decks and décor for a timeless and welcoming experience.

Illustrations are representative only. Actual layout of ships may vary slightly.

WIND SURF FACTS

- | | |
|---|--|
| GUEST CAPACITY: 342 | SAILS: 7 triangular, self-furling, bridge-operated sails with 26,881 square feet (2,600 square meters) of Dacron surface area |
| GUEST DECKS: 6 | MASTS: 5 at 221 feet (67.5 meters) |
| CREW MEMBERS: 210 | ENGINES: 4 diesel electric generator sets, 2 electrical propulsion motors |
| LENGTH: 535 feet (162 meters) at waterline; 619 feet (188.8 meters) including bowsprit | SPEED: 10 to 12 knots with engines only; up to 15 knots with prevailing wind |
| DRAFT: 16.5 feet (5 meters) | SHIP'S REGISTRY: Bahamas |
| TONNAGE: 14,745 gross registered tons (grt) | |
| BEAM: 66 feet (20 meters) | |